

AV-270 Investment Casting Stainless Steel (CA15) Thermodynamic Steam Trap, Screwed Ends

Features

Body Material Cum Standard	Cast Stainless Steel (ASTM A217 Gr. CA15)
Product Description	Thermodynamic Type with inbuilt Strainer
Trim	13% Cr. (SS 410)
End Details	Screwed Female BSP Parallel Threads (BS-21)
Test Pressure	Body: 900 Psig (Hyd.), Seat: 450 Psig (Hyd.)
Max. Working Temperature	425°C

Notes

Other screwed end specifications can be provided on request.

Suitability

Steam



Material Combination

S.No	Description	No.	Material
1	Cover	1	Stainless Steel
2	Disc	1	Stainless Steel
3	Body	1	Stainless Steel
4	Screen	1	Stainless Steel
5	Plug	1	Stainless Steel

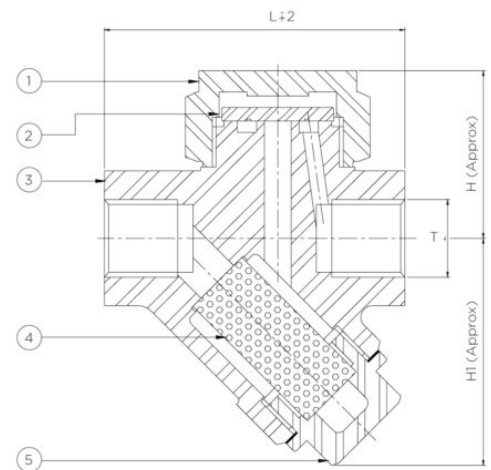

Dimensional Data

Size (mm)	Size (inches)	L	T	H	H1
15	1/2"	78	1/2"	44	61
20	3/4"	78	3/4"	44	61
25	1.1/4"	88	1.1/4"	48	68
40	1.1/2"	108	1.1/2"	70	88
50	2"	108	2"	70	88