

## AV-131 Cast Iron Dual Plate Check Valve, Class-125

### Features

Product Standard	API-594
Testing Standard	API-598
Pressure / Class Rating	Class-125
Body Material Cum Standard	Cast Iron (BS EN 1561 Gr. GJL 220)
Product Description	Wafer Type, Spring Loaded
Type of Seat	Resilient Seated
Trim	Spring: SS 316, Disc - Ductile Iron, Seat: EPDM / Nitrile
End Details	Suitable for clamping between Flanges as per ASME / ANSI B 16.1, Class-125
Test Pressure	Body: 20.7 Bar (Hyd.), Seat: 15.2 Bar (Hyd.)
<b>Suitability</b>	
Water, Oil, Air	



### Material Combination

S.No	Description	No.	Material
1	Body	1	Cast Iron
2	Disc	2	Ductile Iron
3	Disc Holding Pin	1	Stainless Steel
4	Stopper Pin	1	Stainless Steel
5	Disc Holding Plate	2	Cast Iron
6	Spring	2	Stainless Steel
7	Bush	2	Stainless Steel
8	L-Key Screw	4	Carbon Steel
9	Eye Bolt	1	Carbon Steel

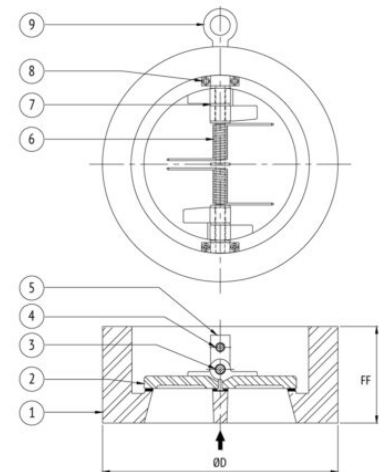

### Dimensional Data

Size (mm)	FF	ØD
50	54	101
65	60	119
80	67	130
100	67	170
125	83	191
150	95	214
200	127	273