

AV-211 Bronze Horizontal Lift Check Valve, Flanged Ends

Features

Body Material Cum Standard	Bronze (IBR 282 (a) (iv) Gr. B)
Product Description	Screwed in Cover
Type of Seat	Renewable Seat
Type of Disc	Renewable Disc
Trim	13% Cr. (SS 410)
End Details	Flanged Ends as per BS-10 Table-H Flat Face (Undrilled)
Test Pressure	Body: 500 Psig (Hyd.)
Max. Working Pressure	250 Psig (Steam)
Max. Working Temperature	225°C

Notes

Test Certificate in Form III-C as per IBR is furnished with every supply.

Suitability

Water, Steam

Material Combination

S.No	Description	No.	Material
1	Body	1	Bronze
2	Body Seat Ring	1	Stainless Steel
3	Disc	1	Stainless Steel
4	Cover	1	Bronze

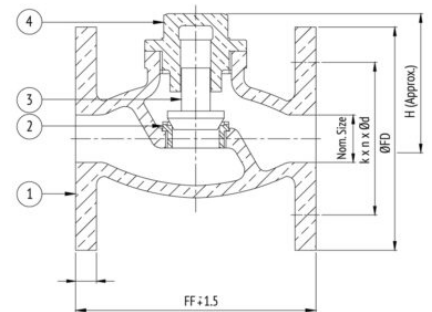

k = P.C.D
n = No. of holes
Ød = Diameter of holes

Dimensional Data

Size (mm)	FF	H	ØFD	FT	k	n	Ød
15	102	55	114.3	9.5	82.6	4	17.5
20	114	55	114.3	9.5	82.6	4	17.5
25	127	64	120.7	11.1	87.3	4	17.5
32	140	74	133.4	11.1	98.4	4	17.5
40	150	80	139.7	12.7	104.8	4	17.5
50	178	90	165.1	12.7	127	4	17.5