

## AV-24 Bronze Feed Check Valve, Screwed Ends

### Features

Type of Pattern	Right Angle Pattern
Body Material Cum Standard	Bronze (BS EN 1982 Gr. CC491K)
Product Description	Screwed in Cover, Vertical Lift
Type of Seat	Integral Seat
Trim	Cu-Alloy
End Details	Screwed Male Inlet BSP Parallel Threads (BS-21)
Test Pressure	Body: 500 Psig (Hyd.), Seat: 250 Psig (Hyd.)

### Notes

Other screwed end specifications can be provided on request.

### Suitability

Water, Oil



### Material Combination

S.No	Description	No.	Material
1	Disc	1	Bronze
2	Body	1	Bronze
3	Cover	1	Bronze

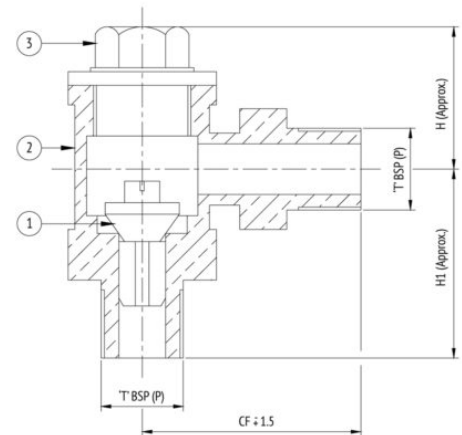

### Dimensional Data

Size (mm)	CF	T	H	H1
15	56	1/2"	36	49
20	63	3/4"	38	58
25	78	1"	42	62
32	85*	1.1/4"	60	70